

Montageanleitung

Technische Daten

Hersteller: mawa design
 Artikelnr.: op7-1/-7
 Spannung: 230 V / 50-60 Hz
 Schutzklasse: II
 Schutzgrad: IP20
 Anschlussleistung: 19W
 Betriebsstrom: 350mA
 Treiber: op7-1 ELT DLC 125/350 A, schaltbar
 Treiber: op7-7 ELT DLC 125/350 A, phasendim.

Technische Daten

Hersteller: mawa design
 Artikelnr.: op7-3/-4/-8
 Spannung: 230 V / 50-60 Hz
 Schutzklasse: II
 Schutzgrad: IP20
 Anschlussleistung: 19W
 Betriebsstrom: 350mA
 Treiber: op7-3 TCI DC Maxi Jolly SLIM HV, 1-10V
 Treiber: op7-4 TCI DC Maxi Jolly SLIM HV, DALI
 Treiber: op7-8 TCI DC Maxi Jolly SLIM HV, PUSH

Schaltplan

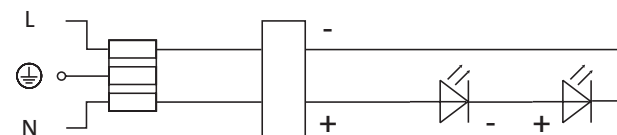

Montage nur durch einen autorisierten Elektroinstallateur!
 Eingriff nur durch autorisiertes Fachpersonal. Nur für Innenraum geeignet.

1

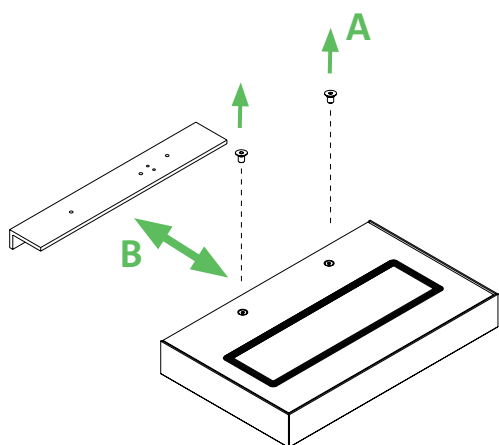

2

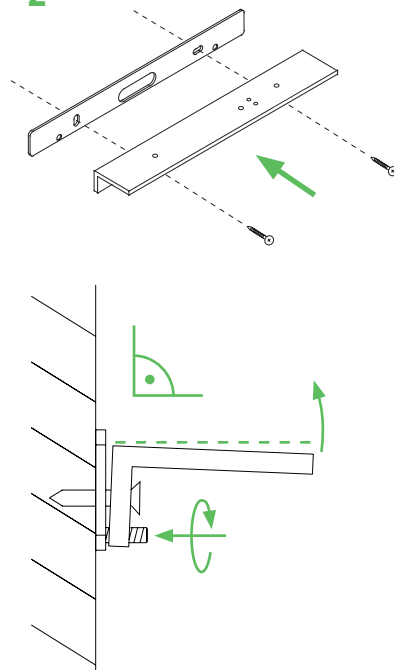

3

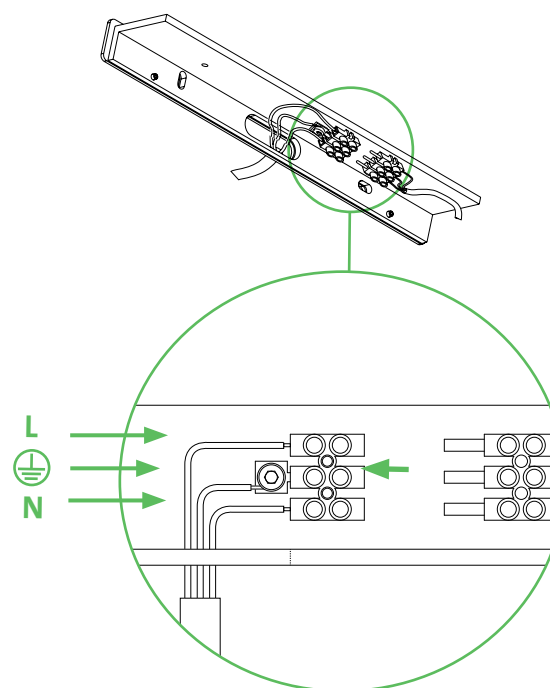

4

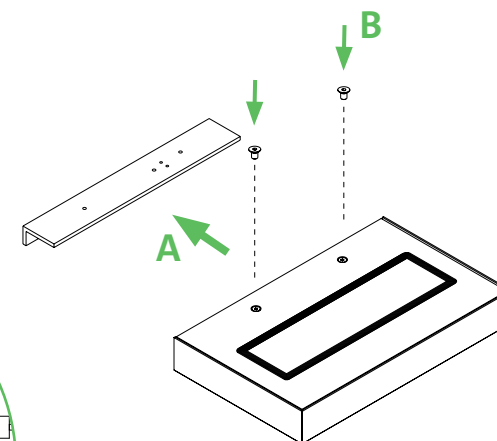

Mounting instructions

Technical Data

Manufacturer: mawa design
Article no.: op7-1/-7
Voltage: 230 V / 50-60 Hz
Protection class: II
Degree of protection: IP20
Connected load: 19W
Operational current: 350mA
op7-1 Driver: ELT DLC 125/350 A, switchable
op7-7 Driver: ELT DLC 125/350 A, leading & trailing edge

Technische Daten

Manufacturer: mawa design
Article no.: op7-3/-4/-8
Voltage: 230 V / 50-60 Hz
Protection class: II
Degree of protection: IP20
Connected load: 19W
Operational current: 350mA
Driver: op7-3 TCI DC Maxi Jolly SLIM HV, 1-10V
Driver: op7-4 TCI DC Maxi Jolly SLIM HV, DALI
Driver: op7-8 TCI DC Maxi Jolly SLIM HV, PUSH

wiring diagram

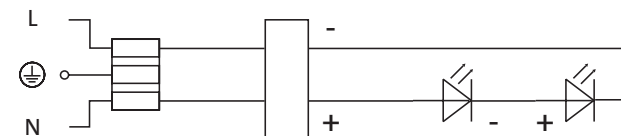

Mounting only by an authorized electrician!
Intervention in the light by authorized technical personal only. Only for indoor use.

