



BROKIS®



# KNOT BATTERY

CM13621

CILINDRO PC1249, CILINDRO SMALL PC1250



Download

### COMPONENTS INCLUDED WITH UNIT:

1x assembled light  
1x hex key size 6 PC1249  
1x hex key size 4 PC1250  
1x wrench size 7  
1x charging cable (Magconn M10PC - RXC2M)  
1x pair cotton gloves  
1x installation manual

### WARNING:

**The manufacturer assumes no liability for damage resulting from incorrect assembly. When unpacking the light, do so with regard for its composition – part of it is made of glass. The light must be charged prior to first use.**

**ATTENTION: PLEASE MAKE ATTENTION DURING THE TRANSFER OF THE LAMP. IT IS NECESSARY TO CARRY IT BY THE BOTTOM PART, DO NOT USE THE ROPE. BROKIS COMPANY WILL NOT ACCEPT A CLAIM IN CASE THAT YOU WILL NOT RESPECT THIS REQUEST.**

**Installation time: 10 minutes / 1 person**



BROKIS S.R.O.  
ŠPANELOVA 1315/25  
163 00 PRAHA 6 - ŘEPY  
CZECH REPUBLIC

ORG. ID 64940799  
VAT ID CZ64940799  
C 42174 MĚSTSKÝ SOUD  
V PRAZE

TEL +420 567 211 517  
TECHNICAL@BROKIS.CZ  
INFO@BROKIS.CZ  
WWW.BROKIS.CZ



### CLEANING THE GLASS

**BROKIS applies the highest possible quality standards in manufacturing its lights. Prior to shipping, each light undergoes several quality controls and stages of cleaning. Lights may require additional cleaning as a result of transportation, storage, and the amount of time that passes between packing in our plant and subsequent unpacking by the client. Therefore, we emphasize cleaning the lights prior to installation.**

**The glass must first be rinsed in hot water, with a dilution of a dish-detergent used to remove all foreign particles and dust. Eventually repeat this basic treatment, if necessary. Afterwards the glass must have a second cleaning using hot water, with a dilution of a de-greaser (such as ammonia or vinegar). The glass must then be thoroughly rinsed with running hot water. Eventually repeat this treatment, if necessary. The glass is then thoroughly dried with a paper towel or a clean soft cotton towel. Only re-assemble the glass to the lamp body, when completely cooled down.**

**Do not use mineral spirits, highly concentrated thinners, or other substances not intended for use on glass surfaces. Also: do not use products, containing silicones – since they will rapidly attract more dust and grease.**

**PRIOR TO SHIPPING, THE FUNCTIONALITY OF EACH LIGHT AND ITS COMPONENTS IS THOROUGHLY TESTED. THE MANUFACTURER ASSUMES NO LIABILITY FOR THE MISHANDLING OF PRODUCTS.**



## 1. SWITCHING ON AND DIMMING THE LIGHT

Place a finger on the bottom edge of the light to turn it on. The same touch is used to increase or decrease the intensity of the light and to switch it off.

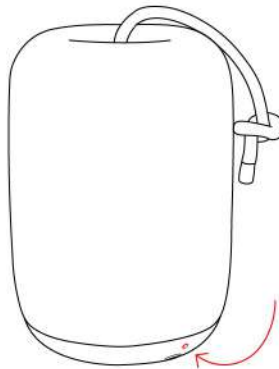

## 2. CLEANING / DISASSEMBLING AND REMOVING THE GLASS 1/3

Always disconnect the light prior to cleaning the internal parts.

- a. Place the light upside down on a soft surface to prevent damaging the glass.
- b. Using the supplied hex key, remove the hex screw from the bottom of the light (hex key size 6 for PC1249; hex key size 4 for PC1250).
- c. Lift the metal bottom off the light and disconnect the wire.
- d. Thread the screw in the centre hole and turn it 3 to 4 times. Use the screw to hold the heat sink with light source in the vertical position.

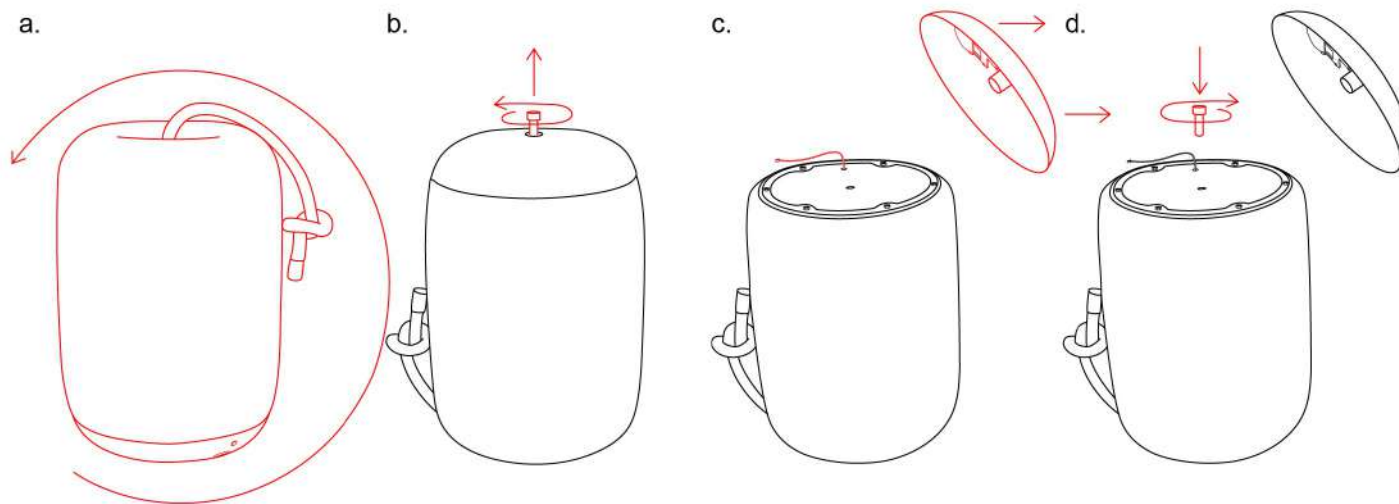

### 3. CLEANING / DISASSEMBLING AND REMOVING THE GLASS 2/3

Unscrew the M4 nuts around the edge of the heat sink using the provided size 7 wrench and remove the stainless-steel ring. Do not let go of the centre screw. Doing so may result in damage to the glass!

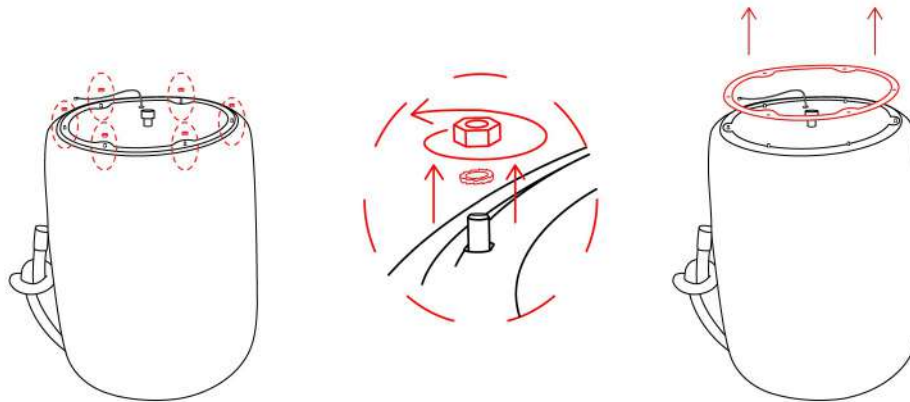

#### 4. CLEANING / DISASSEMBLING AND REMOVING THE GLASS 3/3

Lower the light source assembly into the glass shade. Rotate it 90 degrees to vertical and then carefully pull it out through the slots in the edge of the glass.

Once the light has been cleaned, reassemble it by following the steps in reverse order.

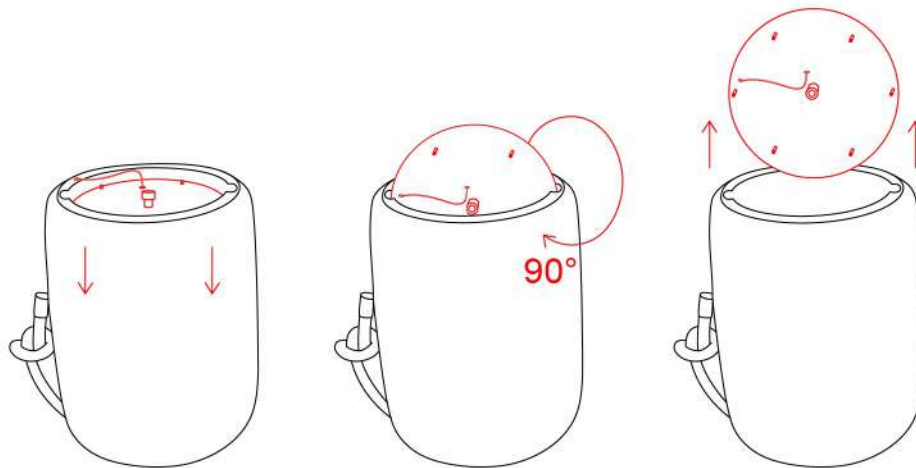

## 5. CHARGING THE LIGHT

Charge the light by attaching the magnetic connector of the charging cable to the bottom edge of the light. Charging is indicated by a blinking green LED. Charging is complete when the LED changes to solid green.

Time to full charge: 6.5 hours.

Battery life from full charge: 4.5 hours.

Recommended charging adapter: 5V / 1.4A - PC1249 / PC1250.

