

BROKIS®

SFERA

500 - PC1172



COMPONENTS OF PACKAGING:

Sfera light, ceiling canopy, power cable, fixture cover, 3 terminal connectors, hex key (size 1.5), hex (size 2), hex key (size 2.5), 2 set screws (M5x16), cotton gloves, installation manual

WARNING:

Installation must be carried out by a qualified electrician only.

Switch off power at main circuit panel prior to installation!

The manufacturer assumes no liability for damage occurring in transport or resulting from incorrect installation.

Instalation time: 30 minutes /1 person



BROKIS S.R.O.
ŠPANIELOVA 1315/25
163 00 PRAHA 6 - ŘEPY
CZECH REPUBLIC

ORG. ID 64940799
VAT ID CZ64940799
C 42174 MĚSTSKÝ SOUD
V PRAZE

TEL +420 567 211 517
TECHNICAL@BROKIS.CZ
INFO@BROKIS.CZ
WWW.BROKIS.CZ

1. INSTALLING THE CEILING BRACKET

Use anchors of sufficient strength (not included) and secure the bracket to the ceiling. With regard to various types of ceilings, we recommend consulting installation with an expert. The manufacturer assumes no liability for incorrect installation, the use of improper anchors, or defects in the material to which the bracket is secured.

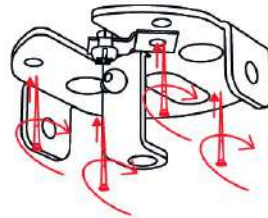

2. INSTALLING THE POWER CABLE

Pass the power cable through the grommet in the ceiling canopy and then through the grommet in the ceiling bracket and secure it with a plastic cable stop. Pass the wire rope inside the power cable through the hole above the plastic cable stop and secure by tightening the screw in the brass ball with the 1.5 hex key. Attach the wire rope to the ground terminal.

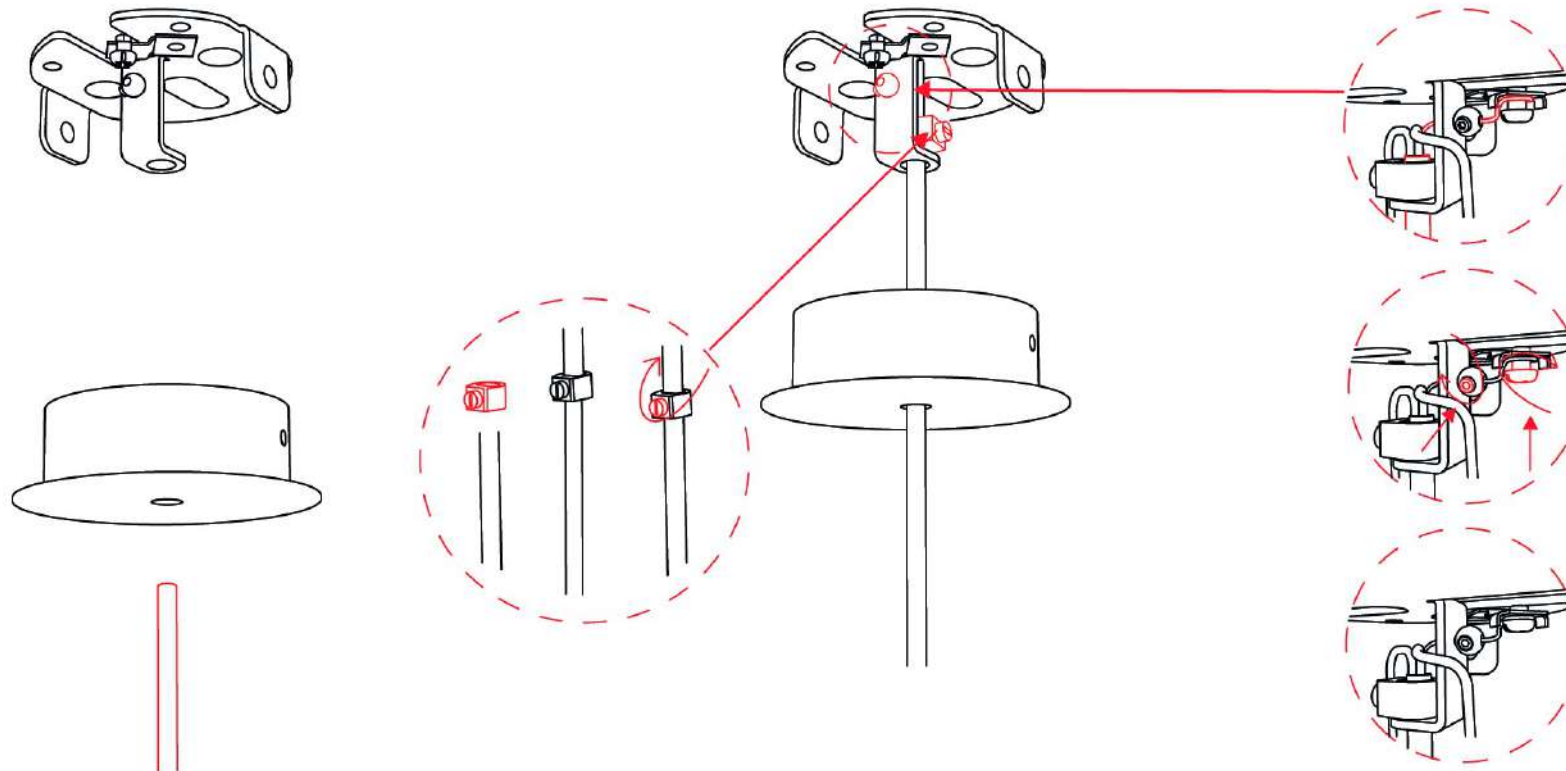

3. CONNECTING THE LIGHT TO THE BUILDING WIRING

Connect the light to the building wiring according to the connection diagram.

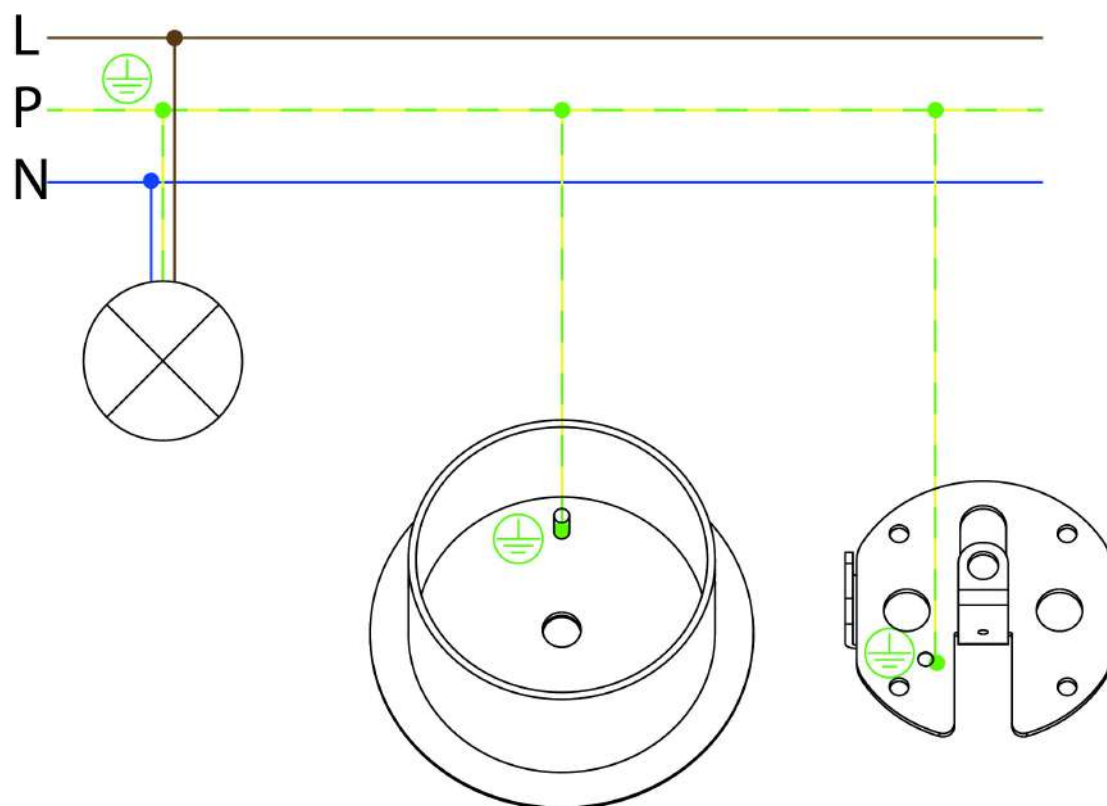

4. INSTALLING THE CEILING CANOPY

Use the two set screws and the hex key to attach the ceiling canopy to the bracket.

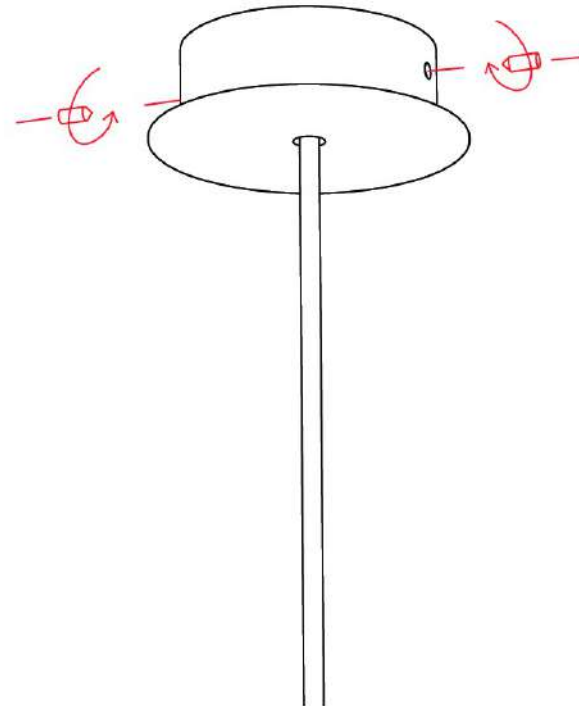
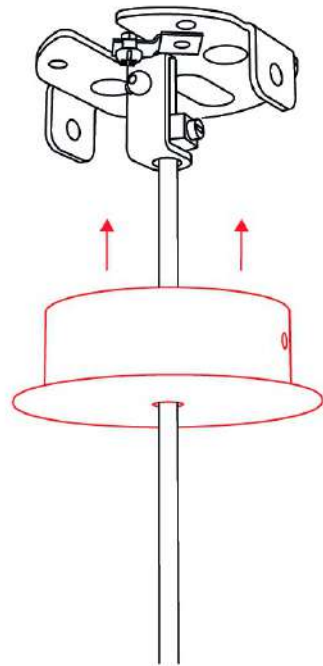

5. INSTALLING THE LIGHT SOURCE

Install the light source. Insert the fixture with the source into the glass shade and fasten four screws (M6x3). Use a size 2 Allen key.

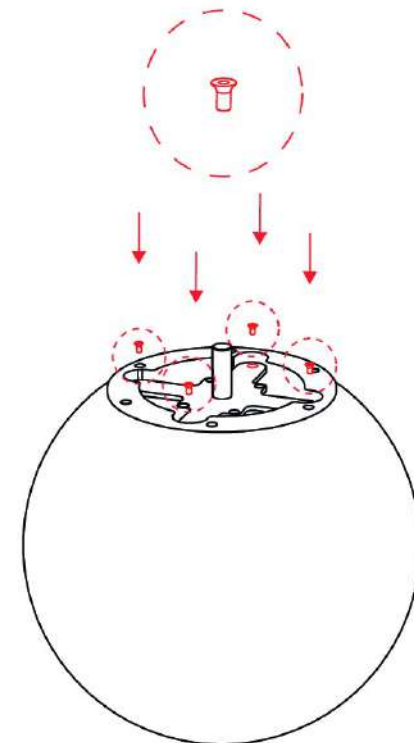
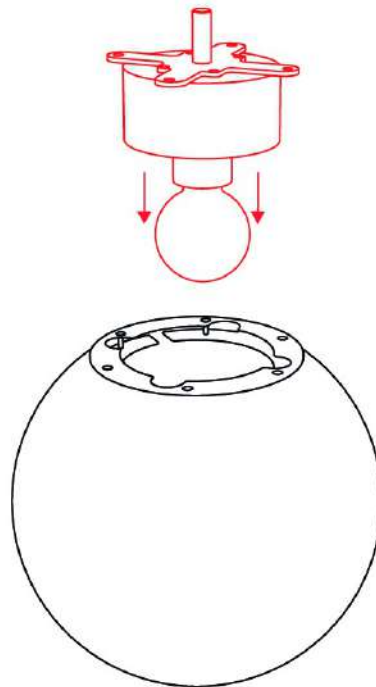
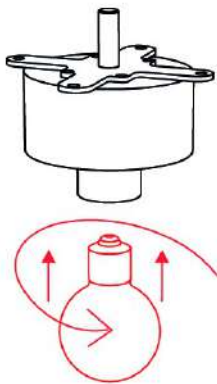

7. INSTALLING THE LIGHT

- Pass the power cable through the fixture cover.
- Loosen the set screw on the power cable connector. Insert the power cable connector into the connector on the light and secure the sleeve by retightening the set screw.
- Connect the ground wire on the fixture cover using the connector.

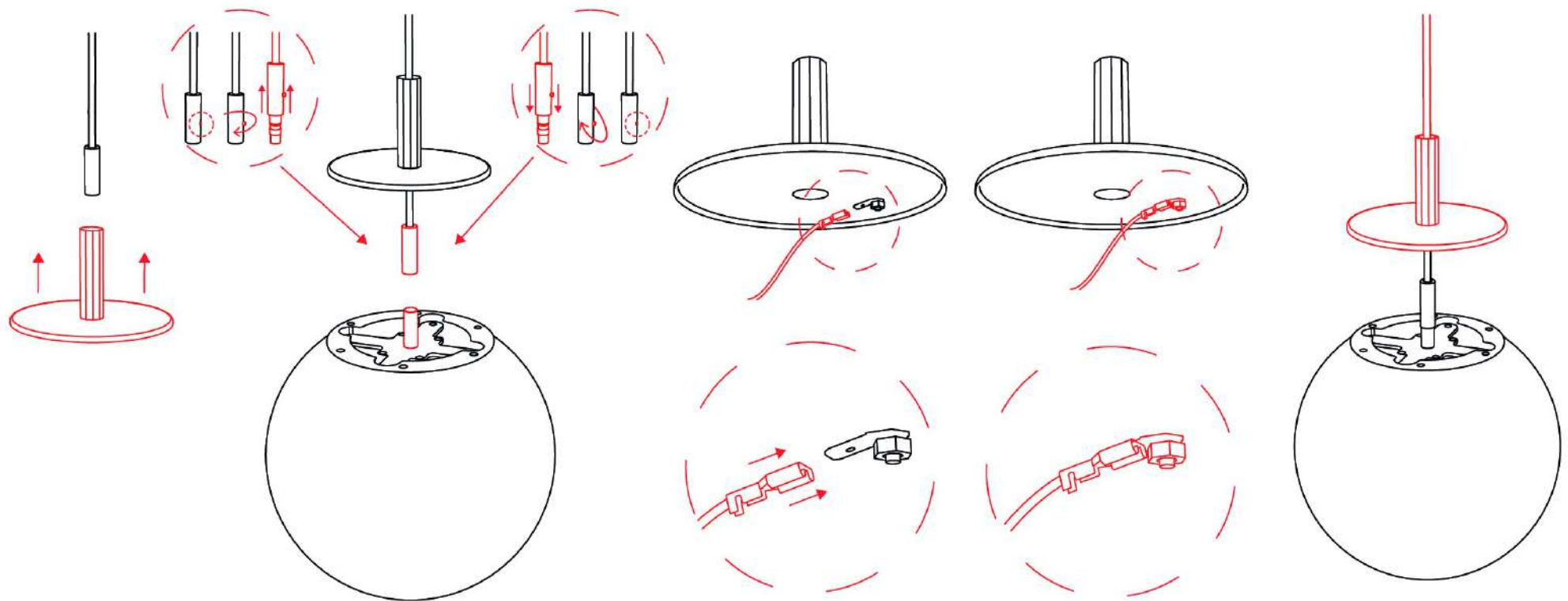

8. SWITCHING ON THE LIGHT

Restore power at the main circuit panel and verify that the light works properly.

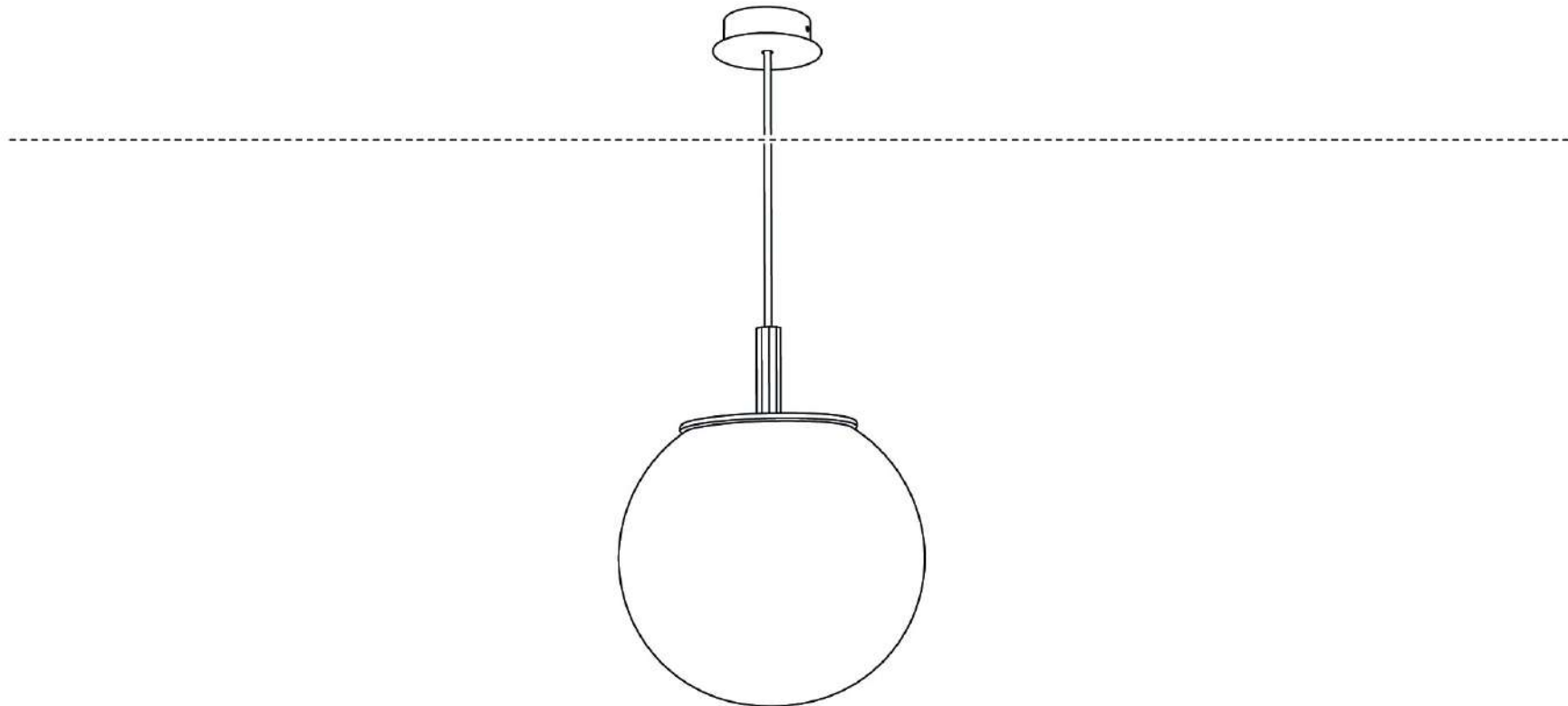



CLEANING THE GLASS

The light can be cleaned using common cleaning agents. Never use solvents or abrasives (scouring powder).

PRIOR TO SHIPPING, THE FUNCTIONALITY OF EACH LIGHT AND ITS COMPONENTS IS THOROUGHLY TESTED. THE MANUFACTURER ASSUMES NO LIABILITY FOR THE MISHANDLING OF PRODUCTS.

CM12320



BROKIS S.R.O.
ŠPANIELOVA 1315/25
163 00 PRAHA 6 - ŘEPY
CZECH REPUBLIC

ORG. ID 64940799
VAT ID CZ64940799
C 42174 MĚSTSKÝ SOUD
V PRAZE

TEL +420 567 211 517
TECHNICAL@BROKIS.CZ
INFO@BROKIS.CZ
WWW.BROKIS.CZ